

**PW920V FIXED WINDOW,
IMPACT RESISTANT, HVHZ
FLANGE, EQUAL-LEG & FIN FRAMES**

DP RATING	LARGE & SMALL
SEE TABLES A-G	MISSILE IMPACT RESISTANT, HVHZ

1) THIS PRODUCT HAS BEEN DESIGNED & TESTED TO COMPLY WITH THE REQUIREMENTS OF THE FLORIDA BUILDING CODE, INCLUDING THE HIGH VELOCITY HURRICANE ZONE (HVHZ).

2) SHUTTERS ARE NOT REQUIRED WHEN USED IN WIND-BORNE DEBRIS REGIONS.

3) MASONRY ANCHORS MAY BE USED INTO WOOD. ALL WOOD BUCKS LESS THAN 1-1/2" THICK ARE TO BE CONSIDERED 1X INSTALLATIONS. 1X WOOD BUCKS ARE OPTIONAL IF UNIT IS INSTALLED DIRECTLY TO SUBSTRATE. WOOD BUCKS DEPICTED AS 2X ARE 1-1/2" THICK OR GREATER.

4) ANCHOR EMBEDMENT TO BASE MATERIAL SHALL BE BEYOND WALL DRESSING OR STUCCO. USE ANCHORS OF SUFFICIENT LENGTH.

5) MAX. 1/4" SHIMS ARE REQUIRED AT EACH ANCHOR LOCATION WHERE THE PRODUCT IS NOT FLUSH TO THE SUBSTRATE. USE SHIMS CAPABLE OF TRANSFERRING APPLIED LOADS.

6) THE ANCHORAGE METHODS SHOWN HAVE BEEN DESIGNED TO RESIST THE WIND LOADS CORRESPONDING TO THE REQUIRED DESIGN PRESSURE. THE 33-1/3% STRESS INCREASE HAS NOT BEEN USED IN THE DESIGN OF THIS PRODUCT. THE 1.6 LOAD DURATION FACTOR WAS USED FOR THE EVALUATION OF ANCHORS INTO WOOD. ANCHORS THAT COME INTO CONTACT WITH OTHER DISSIMILAR MATERIALS SHALL MEET THE REQUIREMENTS OF THE FLORIDA BUILDING CODE FOR CORROSION RESISTANCE.

7) FRAME FLANGES OR INTEGRAL FINNS MAY BE TRIMMED IN-FIELD TO CREATE AN EQUAL-LEG FRAME.

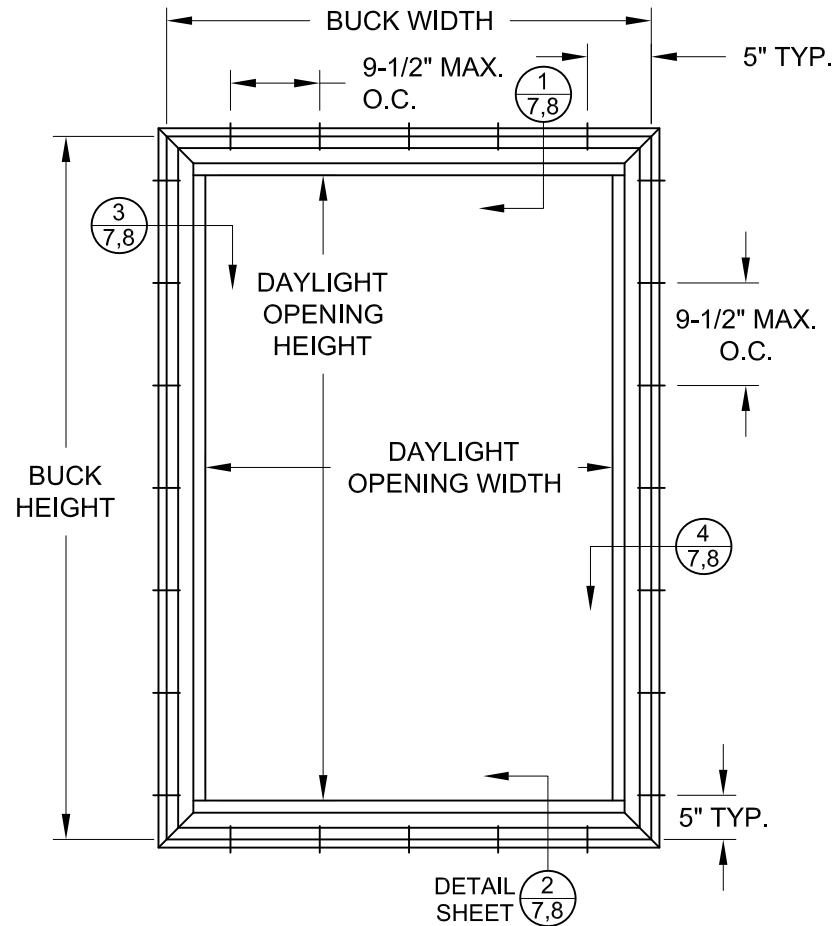

**TYP. ANCHOR LOCATIONS
(FLANGED FRAME, EQUAL-LEG SIM.)**
SEE TABLES A-G FOR SIZES

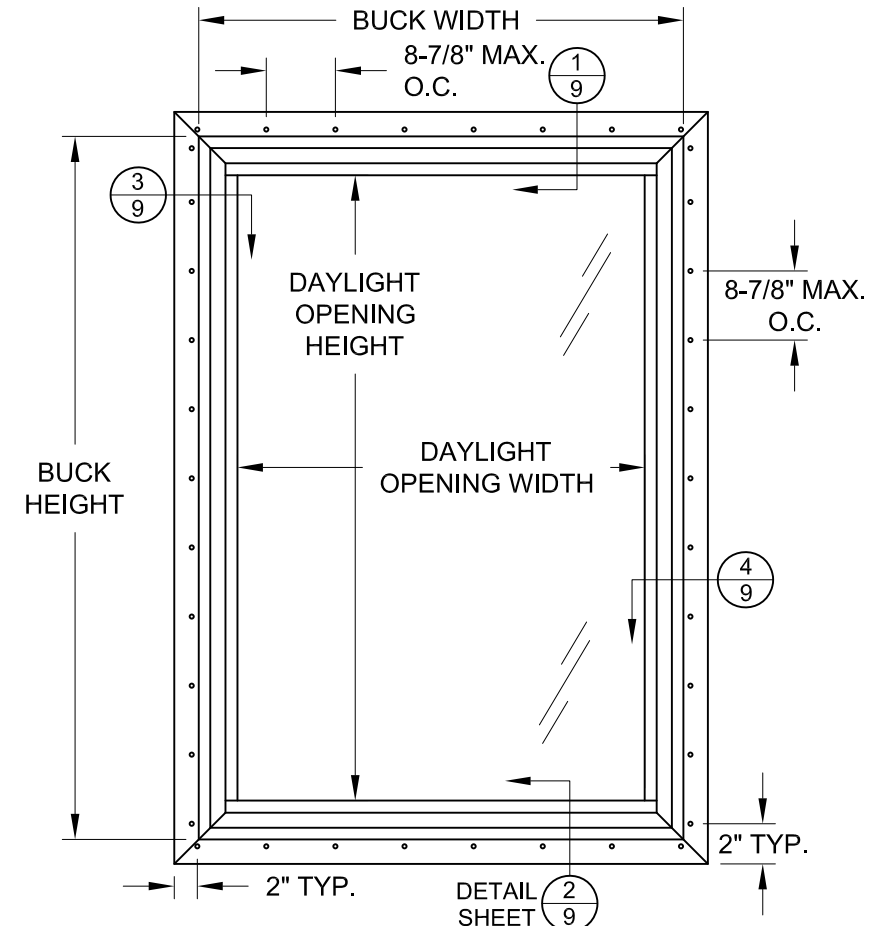

**TYP. ANCHOR LOCATIONS
(INTEGRAL FIN FRAME)**
SEE TABLES A-G FOR SIZES

SHAPES AS SHOWN BELOW, OR SIMILAR, MAY BE USED BY INSCRIBING THE SHAPE IN A BLOCK AND OBTAINING DESIGN PRESSURES FOR THAT BLOCK SIZE FROM THE TABLES ON SHEETS 2-6.

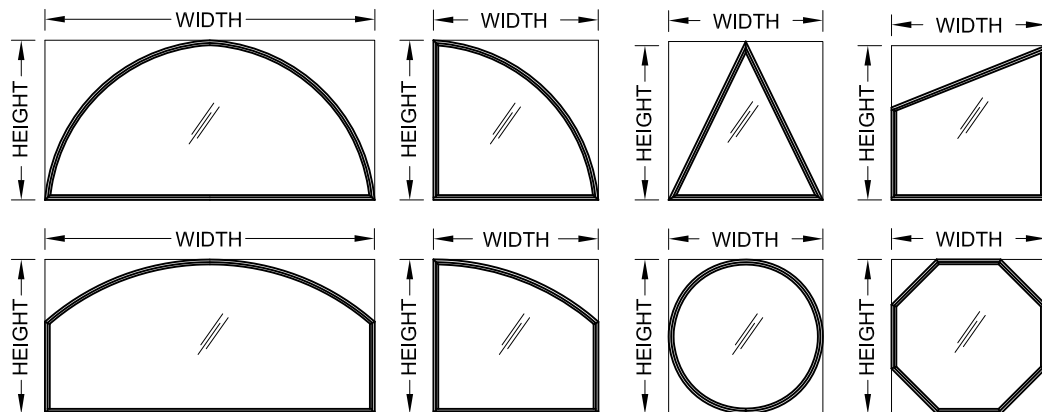

ALL TEMPERED AND/OR LAMINATED GLASS OPTIONS IN THIS APPROVAL HAVE BEEN CERTIFIED BY THE SGCC FOR COMPLIANCE TO ANSI Z97.1, CLASS A AND CPSC 16 CFR 1201, CATEGORY II. THIS INCLUDES LAMINATED GLASS THAT IS MANUFACTURED WITH ANNEALED GLASS PLYS. FOR APPLICATIONS WHERE THE WINDOW IS BEING USED AS A GUARD, HEAT STRENGTHENED OR TEMPERED LAMINATED GLASS MUST BE USED.

DAYLIGHT OPENING WIDTH = BUCK WIDTH - 4.25
DAYLIGHT OPENING HEIGHT = BUCK HEIGHT - 4.25

Rev.# 08/17/23
Date 08/17/23
MINOR EDITORIAL UPDATES
A

PREPARED BY A. LYNN MILLER 1070 TECHNOLOGY DRIVE N. VENICE, FL 34275 (941) 480-1600	REGISTRATION #29296	04/17/23	LOGAN YODER Drawn By	PW920V-FPA-LM HVHZ DWG No.
	COPYRIGHT © 2023 PGT, INC., LIMITED LICENSE TO MAKE COPIES FOR PERMITTING.			
Impact Resistant Windows & Doors CGI WINDOWS AND DOORS 3780 W. 104TH STREET HIALEAH, FL 33018	VINYL FIXED WINDOW (LM - HVHZ)		ELEVATION & GENERAL NOTES	1 OF 10 Sheet
	PW920V			

ANTHONY LYNN MILLER
 LICENSE
 No. 58705
A. Lynn Miller
 08/18/23
 STATE OF
 FLORIDA
 PROFESSIONAL ENGINEER
 A. LYNN MILLER, P.E.
 P.E.# 58705

TABLE A:

Window Design Pressure (+/- psf)																				
Glass Type 1: 7/8" LIG: (1/8" A - AIRSPACE - 5/16" A/A .090" PVB)																				
WINDOW DIMENSIONS	Long Side (in.)																			
	48	50	52	54	56	58	60	62	64	66	68	70	72	74	76	78	80	82	84	
Short Side (in.)	18	70.0	70.0	70.0	70.0	70.0	70.0	70.0	70.0	70.0	70.0	70.0	70.0	70.0	70.0	70.0	70.0	70.0	70.0	
	20	70.0	70.0	70.0	70.0	70.0	70.0	70.0	70.0	70.0	70.0	70.0	70.0	70.0	70.0	70.0	70.0	70.0	70.0	
	22	70.0	70.0	70.0	70.0	70.0	70.0	70.0	70.0	70.0	70.0	70.0	70.0	70.0	70.0	70.0	70.0	70.0	70.0	
	24	70.0	70.0	70.0	70.0	70.0	70.0	70.0	70.0	70.0	70.0	70.0	70.0	70.0	70.0	70.0	70.0	70.0	70.0	
	26	70.0	70.0	70.0	70.0	70.0	70.0	70.0	70.0	70.0	70.0	70.0	70.0	70.0	70.0	70.0	70.0	69.6	68.2	
	28	70.0	70.0	70.0	70.0	70.0	70.0	70.0	70.0	70.0	70.0	70.0	70.0	69.0	66.9	65.2	64.1	63.0	62.1	61.3
	30	70.0	70.0	70.0	70.0	70.0	70.0	70.0	70.0	70.0	70.0	68.2	65.0	63.3	62.0	60.8	59.6	58.4	57.4	56.3
	32	70.0	70.0	70.0	70.0	70.0	70.0	70.0	70.0	70.0	67.8	64.6	62.4	60.6	58.7	57.0	55.7	54.5		
	34	70.0	70.0	70.0	70.0	70.0	70.0	70.0	70.0	67.9	64.8	62.6	60.8	58.8	56.9	54.9				
	36	70.0	70.0	70.0	70.0	70.0	70.0	70.0	67.3	64.5	62.7	61.1	59.3	57.4						
	38	70.0	70.0	70.0	70.0	70.0	70.0	67.2	64.4	62.5	60.9	59.2								
	40	70.0	70.0	70.0	70.0	70.0	67.6	64.6	62.7	60.9										
	42	70.0	70.0	70.0	70.0	68.2	65.0	62.9												
	44	70.0	70.0	70.0	69.2	65.8	63.3													
	46	70.0	70.0	70.0	67.2	64.0														
48	70.0	70.0	68.8	65.2																

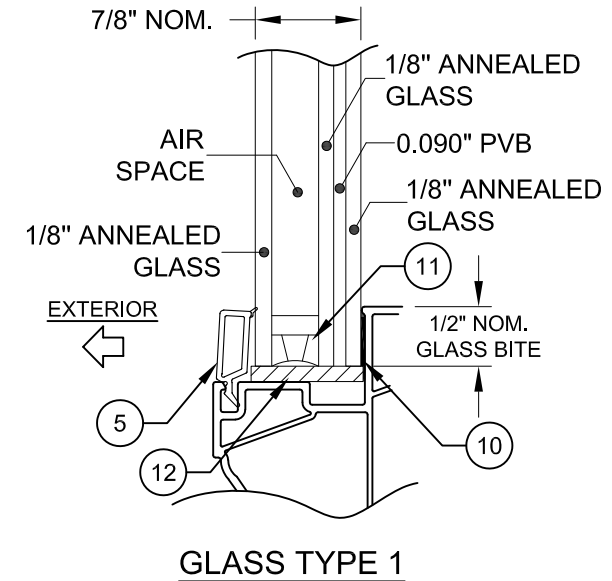
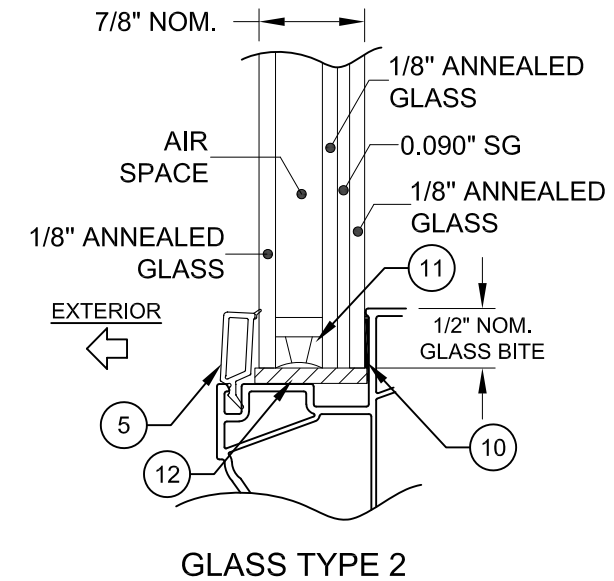

TABLE B:

Window Design Pressure (+/- psf)																				
Glass Type 2: 7/8" LIG: (1/8" A - AIRSPACE - 5/16" A/A .090" SG)																				
WINDOW DIMENSIONS	Long Side (in.)																			
	62	64	66	68	70	72	74	76	78	80	82	84	86	88	90	92	94	96	98	
Short Side (in.)	32	60.0	60.0	60.0	60.0	60.0	60.0	60.0	60.0	60.0	60.0	60.0	60.0	60.0	60.0	60.0	60.0	60.0	60.0	
	34	60.0	60.0	60.0	60.0	60.0	60.0	60.0	60.0	60.0	60.0	60.0	60.0	60.0	60.0	60.0	60.0	60.0	60.0	
	36	60.0	60.0	60.0	60.0	60.0	60.0	60.0	60.0	60.0	60.0	60.0	60.0	60.0	60.0	60.0	59.2	58.4	57.6	56.9
	38	60.0	60.0	60.0	60.0	60.0	60.0	60.0	60.0	60.0	60.0	60.0	60.0	60.0	58.7	57.4	56.3	55.5	54.7	53.9
	40	60.0	60.0	60.0	60.0	60.0	60.0	60.0	60.0	60.0	60.0	60.0	59.6	58.1	56.7	55.2	53.8	52.8	51.9	51.1
	42	60.0	60.0	60.0	60.0	60.0	60.0	60.0	60.0	60.0	59.4	57.9	56.3	54.8	53.4	52.3	51.2	50.2	49.1	47.6
	44	60.0	60.0	60.0	60.0	60.0	60.0	60.0	59.8	58.6	57.4	56.1	54.7	53.2	52.0	50.9	49.8	48.7	47.6	46.2
	46	60.0	60.0	60.0	60.0	60.0	60.0	59.1	57.8	56.5	55.2	53.9	52.9	51.8	50.8	49.6	48.4	47.3	46.2	44.8
	48	60.0	60.0	60.0	60.0	60.0	58.7	57.3	55.9	54.6	53.3	52.2	51.2	50.2	49.2	48.2	47.2	46.0	44.8	43.5
	50	60.0	60.0	60.0	60.0	59.4	58.3	57.0	55.6	54.1	52.9	51.7	50.6	49.6	48.6	47.5	46.5	45.6	44.6	43.0
	52	60.0	60.0	60.0	58.7	57.4	56.1	55.0	53.8	52.7	51.4	50.3	49.1	48.0	46.9	45.9	44.9	43.8	43.0	
	54	60.0	59.6	58.1	56.7	55.3	54.1	53.0	52.0	51.1	50.1	48.9	47.7	46.5	45.4	44.3	43.2			
	56	59.4	57.7	56.2	54.7	53.4	52.3	51.2	50.3	49.3	48.4	47.4	46.3	45.1	43.9	42.8				
	58	57.6	55.9	54.3	53.0	51.8	50.7	49.6	48.6	47.6	46.6	45.6	44.7	43.7						
	60	55.9	54.1	52.7	51.5	50.3	49.2	48.0	47.0	45.9	44.9	43.9	43.0							
62	54.1	52.6	51.3	50.1	48.9	47.7	46.5	45.4	44.3	43.2										



NOTES: 1) FOR SIZES NOT SHOWN, ROUND UP TO THE NEXT AVAILABLE WIDTH OR HEIGHT DIMENSION.
 2) GLASS TYPES 3, 4, 6 OR 8 MUST BE USED ABOVE 30 FT IN THE HVHZ.

Rev.# 08/17/23
 Date 08/17/23
 MINOR EDITORIAL UPDATES

Impact Resistant Windows & Doors
 CGI WINDOWS AND DOORS
 3780 W. 104TH STREET
 HIALEAH, FL 33018
 REGISTRATION #29296
 COPYRIGHT © 2023 PGT, INC., LIMITED LICENSE
 TO MAKE COPIES FOR PERMITTING.
 (941) 480-1600

Prepared by: A. LYNN MILLER
 1070 TECHNOLOGY DRIVE
 N. VENICE, FL 34275

VINYL FIXED WINDOW (LM - HVHZ)
 DATE: 04/17/23
 DRAWN BY: LOGAN YODER

DP TABLES & GLASS TYPES
 PW920V

2 OF 10
 PW920V-FPA-LM HVHZ

Series Desc. Title
 No. 58705
 State of Florida
 License
 Anthony Lynn Miller
 Professional Engineer
 No. 58705
 08/18/23
 State of Florida
 A. LYNN MILLER, P.E.
 P.E.# 58705

TABLE C:

Window Design Pressure (+/- psf)																									
Glass Type 3: 7/8" LIG: (1/8" T - AIRSPACE - 5/16" A/A .090" PVB)																									
WINDOW DIMENSIONS	Long Side (in.)																								
	48	50	52	54	56	58	60	62	64	66	68	70	72	74	76	78	80	82	84						
Short Side (in.)	18	70.0	70.0	70.0	70.0	70.0	70.0	70.0	70.0	70.0	70.0	70.0	70.0	70.0	70.0	70.0	70.0	70.0	70.0	70.0					
	20	70.0	70.0	70.0	70.0	70.0	70.0	70.0	70.0	70.0	70.0	70.0	70.0	70.0	70.0	70.0	70.0	70.0	70.0	70.0	70.0				
	22	70.0	70.0	70.0	70.0	70.0	70.0	70.0	70.0	70.0	70.0	70.0	70.0	70.0	70.0	70.0	70.0	70.0	70.0	70.0	70.0				
	24	70.0	70.0	70.0	70.0	70.0	70.0	70.0	70.0	70.0	70.0	70.0	70.0	70.0	70.0	70.0	70.0	70.0	70.0	70.0	70.0	70.0			
	26	70.0	70.0	70.0	70.0	70.0	70.0	70.0	70.0	70.0	70.0	70.0	70.0	70.0	70.0	70.0	70.0	70.0	70.0	70.0	70.0	70.0			
	28	70.0	70.0	70.0	70.0	70.0	70.0	70.0	70.0	70.0	70.0	70.0	70.0	70.0	70.0	70.0	70.0	70.0	70.0	69.0	68.1				
	30	70.0	70.0	70.0	70.0	70.0	70.0	70.0	70.0	70.0	70.0	70.0	70.0	70.0	68.9	67.5	66.2	64.9	63.8	62.6					
	32	70.0	70.0	70.0	70.0	70.0	70.0	70.0	70.0	70.0	70.0	70.0	69.4	67.3	65.2	63.3	61.9	60.6							
	34	70.0	70.0	70.0	70.0	70.0	70.0	70.0	70.0	70.0	70.0	69.6	67.5	65.4	63.2	61.0									
	36	70.0	70.0	70.0	70.0	70.0	70.0	70.0	70.0	70.0	69.7	67.8	65.9	63.7											
	38	70.0	70.0	70.0	70.0	70.0	70.0	70.0	70.0	69.5	67.6	65.8													
	40	70.0	70.0	70.0	70.0	70.0	70.0	70.0	69.6	67.6															
	42	70.0	70.0	70.0	70.0	70.0	70.0	69.2																	
	44	70.0	70.0	70.0	70.0	70.0	69.2																		
	46	70.0	70.0	70.0	70.0	69.7																			
48	70.0	70.0	70.0	70.0																					

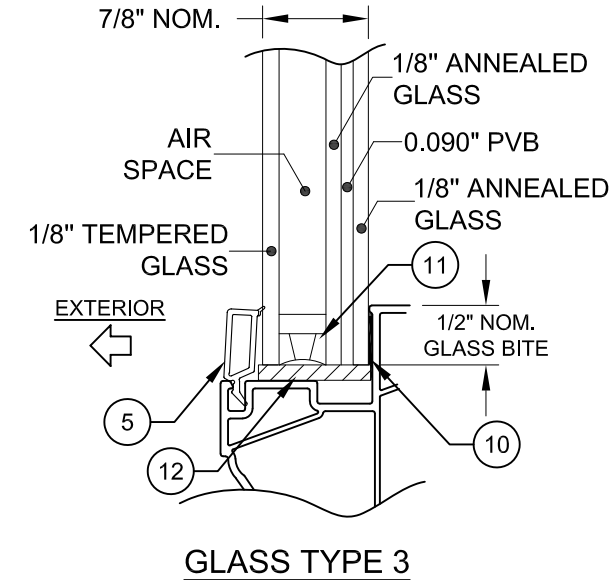
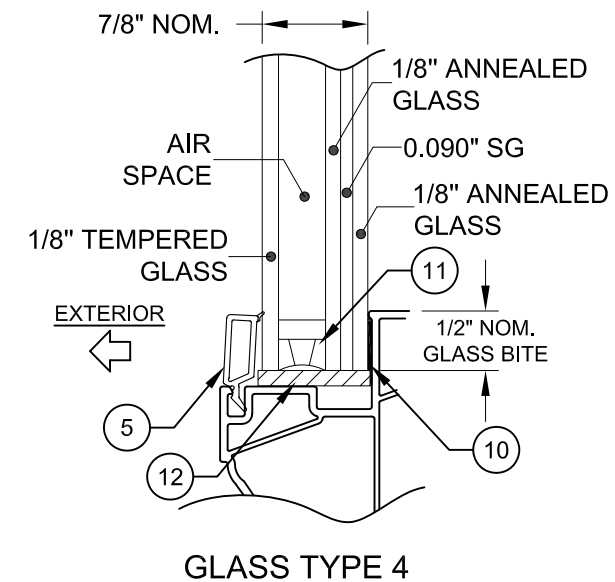

TABLE D:

Window Design Pressure (+/- psf)																								
Glass Type 4: 7/8" LIG: (1/8" T - AIRSPACE - 5/16" A/A .090" SG)																								
WINDOW DIMENSIONS	Long Side (in.)																							
	62	64	66	68	70	72	74	76	78	80	82	84	86	88	90	92	94	96	98					
Short Side (in.)	32	60.0	60.0	60.0	60.0	60.0	60.0	60.0	60.0	60.0	60.0	60.0	60.0	60.0	60.0	60.0	60.0	60.0	60.0	60.0	60.0			
	34	60.0	60.0	60.0	60.0	60.0	60.0	60.0	60.0	60.0	60.0	60.0	60.0	60.0	60.0	60.0	60.0	60.0	60.0	60.0	60.0	60.0		
	36	60.0	60.0	60.0	60.0	60.0	60.0	60.0	60.0	60.0	60.0	60.0	60.0	60.0	60.0	60.0	60.0	60.0	60.0	60.0	60.0	60.0	60.0	
	38	60.0	60.0	60.0	60.0	60.0	60.0	60.0	60.0	60.0	60.0	60.0	60.0	60.0	60.0	60.0	60.0	60.0	60.0	60.0	60.0	60.0	60.0	60.0
	40	60.0	60.0	60.0	60.0	60.0	60.0	60.0	60.0	60.0	60.0	60.0	60.0	60.0	60.0	60.0	60.0	60.0	60.0	60.0	60.0	60.0	60.0	60.0
	42	60.0	60.0	60.0	60.0	60.0	60.0	60.0	60.0	60.0	60.0	60.0	60.0	60.0	60.0	60.0	60.0	60.0	60.0	60.0	60.0	60.0	60.0	60.0
	44	60.0	60.0	60.0	60.0	60.0	60.0	60.0	60.0	60.0	60.0	60.0	60.0	60.0	60.0	60.0	60.0	60.0	60.0	60.0	60.0	60.0	60.0	60.0
	46	60.0	60.0	60.0	60.0	60.0	60.0	60.0	60.0	60.0	60.0	60.0	60.0	60.0	60.0	60.0	60.0	60.0	60.0	60.0	60.0	60.0	60.0	60.0
	48	60.0	60.0	60.0	60.0	60.0	60.0	60.0	60.0	60.0	60.0	60.0	60.0	60.0	60.0	60.0	60.0	60.0	60.0	60.0	60.0	60.0	60.0	60.0
	50	60.0	60.0	60.0	60.0	60.0	60.0	60.0	60.0	60.0	60.0	60.0	60.0	60.0	60.0	60.0	60.0	60.0	60.0	60.0	60.0	60.0	60.0	60.0
	52	60.0	60.0	60.0	60.0	60.0	60.0	60.0	60.0	60.0	60.0	60.0	60.0	60.0	60.0	60.0	60.0	60.0	60.0	60.0	60.0	60.0	60.0	60.0
	54	60.0	60.0	60.0	60.0	60.0	60.0	60.0	60.0	60.0	60.0	60.0	60.0	60.0	60.0	60.0	60.0	60.0	60.0	60.0	60.0	60.0	60.0	60.0
	56	60.0	60.0	60.0	60.0	60.0	60.0	60.0	60.0	60.0	60.0	60.0	60.0	60.0	60.0	60.0	60.0	60.0	60.0	60.0	60.0	60.0	60.0	60.0
	58	60.0	60.0	60.0	60.0	60.0	60.0	60.0	60.0	60.0	60.0	60.0	60.0	60.0	60.0	60.0	60.0	60.0	60.0	60.0	60.0	60.0	60.0	60.0
	60	60.0	60.0	60.0	60.0	60.0	60.0	60.0	60.0	60.0	60.0	60.0	60.0	60.0	60.0	60.0	60.0	60.0	60.0	60.0	60.0	60.0	60.0	60.0
62	60.0	60.0	60.0	60.0	60.0	60.0	60.0	60.0	60.0	60.0	60.0	60.0	60.0	60.0	60.0	60.0	60.0	60.0	60.0	60.0	60.0	60.0	60.0	



NOTES: 1) FOR SIZES NOT SHOWN, ROUND UP TO THE NEXT AVAILABLE WIDTH OR HEIGHT DIMENSION.
 2) GLASS TYPES 3, 4, 6 OR 8 MUST BE USED ABOVE 30 FT IN THE HVHZ.

Rev.# 08/17/23
 Date
 MINOR EDITORIAL UPDATES

PREPARED BY A. LYNN MILLER 1070 TECHNOLOGY DRIVE N. VENICE, FL 34275 (941) 480-1600	REGISTRATION #29296 COPYRIGHT © 2023 PGT, INC., LIMITED LICENSE TO MAKE COPIES FOR PERMITTING.	Date 04/17/23	By LOGAN YODER	No. PW920V-FPA-LM HVHZ
	Impact Resistant Windows & Doors CGI WINDOWS AND DOORS 3780 W. 104TH STREET HIALEAH, FL 33018	Title VINYL FIXED WINDOW (LM - HVHZ)		
Series Desc. Title DP TABLES & GLASS TYPES PW920V				

ANTHONY LYNN MILLER
 LICENSE
 No. 58705
 08/18/23
 STATE OF FLORIDA
 PROFESSIONAL ENGINEER
 A. LYNN MILLER, P.E.
 P.E.# 58705

TABLE E:

Window Design Pressure (+/- psf)																	
Glass Type 5: 7/8" LIG: (3/16" A - AIRSPACE - 5/16" A/A .090" PVB)																	
Glass Type 6: 7/8" LIG: (3/16" T - AIRSPACE - 5/16" A/A .090" PVB)																	
WINDOW DIMENSIONS	Long Side (in.)																
	54	56	58	60	62	64	66	68	70	72	74	76	78	80	82	84	
Short Side (in.)	30	70.0	70.0	70.0	70.0	70.0	70.0	70.0	70.0	70.0	70.0	70.0	70.0	70.0	70.0	70.0	70.0
	32	70.0	70.0	70.0	70.0	70.0	70.0	70.0	70.0	70.0	70.0	70.0	70.0	70.0			
	34	70.0	70.0	70.0	70.0	70.0	70.0	70.0	70.0	70.0	70.0	70.0					
	36	70.0	70.0	70.0	70.0	70.0	70.0	70.0	70.0	70.0							
	38	70.0	70.0	70.0	70.0	70.0	70.0	69.8	69.0								
	40	70.0	70.0	70.0	70.0	69.8	68.7										
	42	70.0	70.0	70.0	69.2												
	44	70.0	70.0	69.2													
	46	70.0	69.7														
	48	70.0															

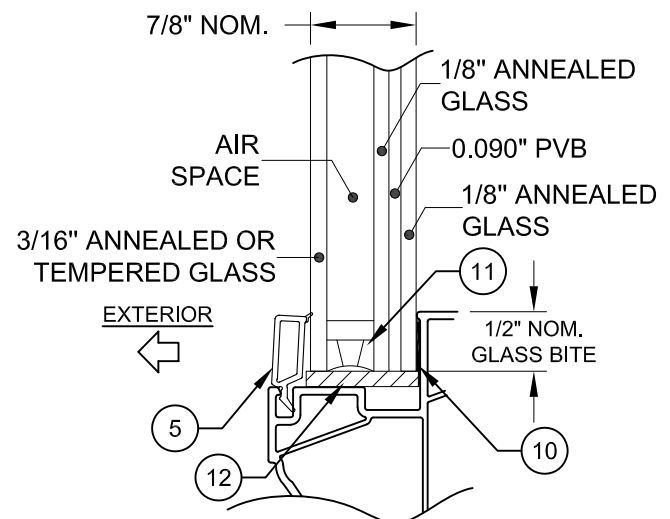

GLASS TYPE 5 (WITH ANNEALED CAP)
GLASS TYPE 6 (WITH TEMPERED CAP)

NOTES: 1) FOR SIZES NOT SHOWN, ROUND UP TO THE NEXT AVAILABLE WIDTH OR HEIGHT DIMENSION.
2) GLASS TYPES 3, 4, 6 OR 8 MUST BE USED ABOVE 30 FT IN THE HVHZ.

Impact Resistant Windows & Doors CGI WINDOWS AND DOORS 3780 W. 104TH STREET HIALEAH, FL 33018	PREPARED BY A. LYNN MILLER 1070 TECHNOLOGY DRIVE N. VENICE, FL 34275 (941) 480-1600	REGISTRATION #29296 COPYRIGHT © 2023 PGT, INC., LIMITED LICENSE TO MAKE COPIES FOR PERMITTING.	04/17/23 Date
	VINYL FIXED WINDOW (LM - HVHZ)	LOGAN YODER By	PW920V-FPA-LM HVHZ No.
4 OF 10 Sheet	PW920V	DP TABLES & GLASS TYPES	4 OF 10 DWG

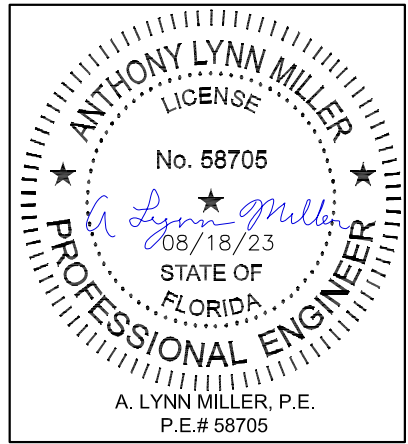
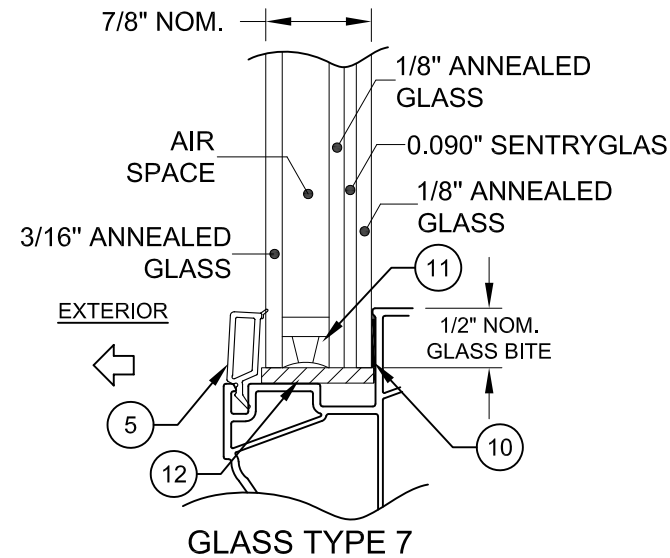

TABLE F:

Window Design Pressure (+/- psf)																											
Glass Type 7: 7/8" LIG: (3/16" A - AIRSPACE - 5/16" A/A .090" SG)																											
WINDOW DIMENSIONS	Long Side (in.)																										
	70.875	72	74	76	78	80	82	84	86	88	90	92	94	96	98	100	102	104	106	108	110	112	114	116	118	120	
40	60.0	60.0	60.0	60.0	60.0	60.0	60.0	60.0	60.0	60.0	60.0	60.0	60.0	60.0	60.0	60.0	60.0	60.0	60.0	59.0	58.0	57.0	55.8	54.8	53.8	53.0	52.4
42	60.0	60.0	60.0	60.0	60.0	60.0	60.0	60.0	60.0	60.0	60.0	60.0	60.0	60.0	60.0	60.0	60.0	58.8	57.3	55.8	54.2	53.1	52.2	51.4	50.8	50.0	
44	60.0	60.0	60.0	60.0	60.0	60.0	60.0	60.0	60.0	60.0	60.0	60.0	60.0	60.0	60.0	60.0	59.9	58.0	56.3	54.7	53.2	52.1	51.1				
46	60.0	60.0	60.0	60.0	60.0	60.0	60.0	60.0	60.0	60.0	60.0	60.0	60.0	60.0	60.0	60.0	59.9	58.2	56.4	54.6							
48	60.0	60.0	60.0	60.0	60.0	60.0	60.0	60.0	60.0	60.0	60.0	60.0	60.0	60.0	60.0	59.8	58.4	57.5									
50	60.0	60.0	60.0	60.0	60.0	60.0	60.0	60.0	60.0	60.0	60.0	60.0	60.0	60.0	59.5	58.3											
52	60.0	60.0	60.0	60.0	60.0	60.0	60.0	60.0	60.0	60.0	60.0	60.0	60.0	58.8													
54	60.0	60.0	60.0	60.0	60.0	60.0	60.0	60.0	60.0	60.0	60.0	59.1															
56	60.0	60.0	60.0	60.0	60.0	60.0	60.0	60.0	60.0	60.0	58.6																
58	60.0	60.0	60.0	60.0	60.0	60.0	60.0	60.0	59.8																		
60	60.0	60.0	60.0	60.0	60.0	60.0	60.0	58.8																			
62	60.0	60.0	60.0	60.0	60.0	59.1																					
64	60.0	60.0	60.0	60.0	58.6																						
66	60.0	60.0	59.7	58.3																							
68	60.0	59.6	58.1																								
70	58.9	58.1																									
70.875	58.3																										



NOTES: 1) FOR SIZES NOT SHOWN, ROUND UP TO THE NEXT AVAILABLE WIDTH OR HEIGHT DIMENSION.
 2) GLASS TYPES 3, 4, 6 OR 8 MUST BE USED ABOVE 30 FT IN THE HVHZ.

Rev. # 08/17/23
 Date
 MINOR EDITORIAL UPDATES

PREPARED BY A. LYNN MILLER 1070 TECHNOLOGY DRIVE N. VENICE, FL 34275 (941) 480-1600	REGISTRATION #29296 COPYRIGHT © 2023 PGT, INC., LIMITED LICENSE TO MAKE COPIES FOR PERMITTING.	Date 04/17/23
	Drawn By LOGAN YODER	No. PW920V-FPA-LM HVHZ
Impact Resistant Windows & Doors CGI WINDOWS AND DOORS 3780 W. 104TH STREET HIALEAH, FL 33018	VINYL FIXED WINDOW (LM - HVHZ)	Sheet 5 OF 10
DP TABLES & GLASS TYPES	Series PW920V	Title DP TABLES & GLASS TYPES

ANTHONY LYNN MILLER
 LICENSE
 No. 58705
 08/18/23
 STATE OF FLORIDA
 PROFESSIONAL ENGINEER
 A. LYNN MILLER, P.E.
 P.E.# 58705

TABLE G:

Window Design Pressure (+/- psf)																											
Glass Type 8: 7/8" LIG: (3/16" T- AIRSPACE - 5/16" A/A .090" SG)																											
WINDOW DIMENSIONS	Long Side (in.)																										
	70.875	72	74	76	78	80	82	84	86	88	90	92	94	96	98	100	102	104	106	108	110	112	114	116	118	120	
40	60.0	60.0	60.0	60.0	60.0	60.0	60.0	60.0	60.0	60.0	60.0	60.0	60.0	60.0	60.0	60.0	60.0	60.0	60.0	60.0	60.0	60.0	60.0	60.0	60.0	60.0	
42	60.0	60.0	60.0	60.0	60.0	60.0	60.0	60.0	60.0	60.0	60.0	60.0	60.0	60.0	60.0	60.0	60.0	60.0	60.0	60.0	60.0	60.0	60.0	60.0	60.0	60.0	
44	60.0	60.0	60.0	60.0	60.0	60.0	60.0	60.0	60.0	60.0	60.0	60.0	60.0	60.0	60.0	60.0	60.0	60.0	60.0	60.0	60.0	60.0	60.0				
46	60.0	60.0	60.0	60.0	60.0	60.0	60.0	60.0	60.0	60.0	60.0	60.0	60.0	60.0	60.0	60.0	60.0	60.0	60.0	60.0							
48	60.0	60.0	60.0	60.0	60.0	60.0	60.0	60.0	60.0	60.0	60.0	60.0	60.0	60.0	60.0	60.0	60.0	60.0									
50	60.0	60.0	60.0	60.0	60.0	60.0	60.0	60.0	60.0	60.0	60.0	60.0	60.0	60.0	60.0	60.0											
52	60.0	60.0	60.0	60.0	60.0	60.0	60.0	60.0	60.0	60.0	60.0	60.0	60.0	60.0													
54	60.0	60.0	60.0	60.0	60.0	60.0	60.0	60.0	60.0	60.0	60.0	60.0															
56	60.0	60.0	60.0	60.0	60.0	60.0	60.0	60.0	60.0	60.0	60.0																
58	60.0	60.0	60.0	60.0	60.0	60.0	60.0	60.0	60.0																		
60	60.0	60.0	60.0	60.0	60.0	60.0	60.0	60.0																			
62	60.0	60.0	60.0	60.0	60.0	60.0																					
64	60.0	60.0	60.0	60.0	60.0																						
66	60.0	60.0	60.0	60.0																							
68	60.0	60.0	60.0																								
70	60.0	60.0																									
70.875	60.0																										

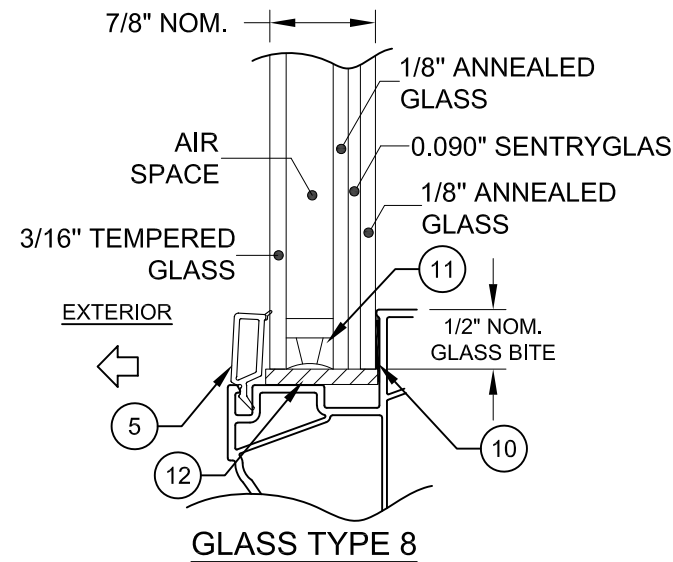

NOTES: 1) FOR SIZES NOT SHOWN, ROUND UP TO THE NEXT AVAILABLE WIDTH OR HEIGHT DIMENSION.
 2) GLASS TYPES 3, 4, 6 OR 8 MUST BE USED ABOVE 30 FT IN THE HVHZ.

Rev. # 08/17/23
 Date 08/17/23
 MINOR EDITORIAL UPDATES
 Rev.

PREPARED BY A. LYNN MILLER 1070 TECHNOLOGY DRIVE N. VENICE, FL 34275 (941) 480-1600	REGISTRATION #29296 COPYRIGHT © 2023 PGT, INC., LIMITED LICENSE TO MAKE COPIES FOR PERMITTING.	04/17/23 Date	LOGAN YODER Drawn By
	VINYL FIXED WINDOW (LM - HVHZ) Desc. Title	PW920V-FPA-LM HVHZ No.	6 OF 10 Sheet

Impact Resistant Windows & Doors
 CGI WINDOWS AND DOORS
 3780 W. 104TH STREET
 HIALEAH, FL 33018

ANTHONY LYNN MILLER
 LICENSE
 No. 58705
 08/18/23
 STATE OF FLORIDA
 PROFESSIONAL ENGINEER
 A. LYNN MILLER, P.E.
 P.E.# 58705

1 HEAD FLANGE FRAME X-SECTION INTO 2X WOOD OR MASONRY

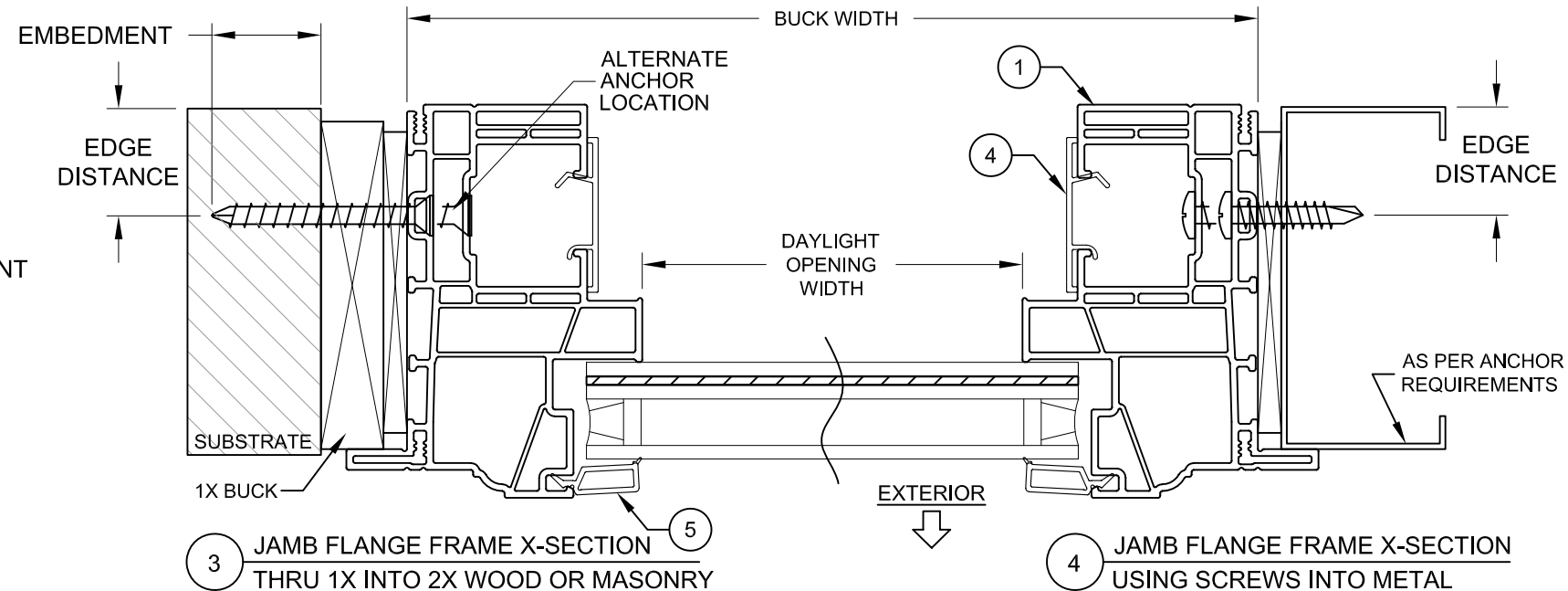
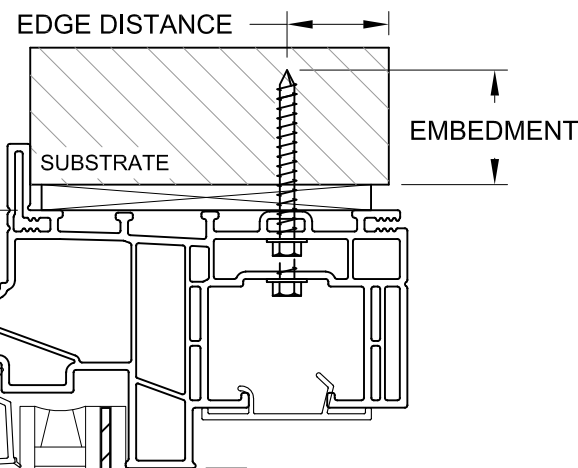

3 JAMB FLANGE FRAME X-SECTION THRU 1X INTO 2X WOOD OR MASONRY

4 JAMB FLANGE FRAME X-SECTION USING SCREWS INTO METAL

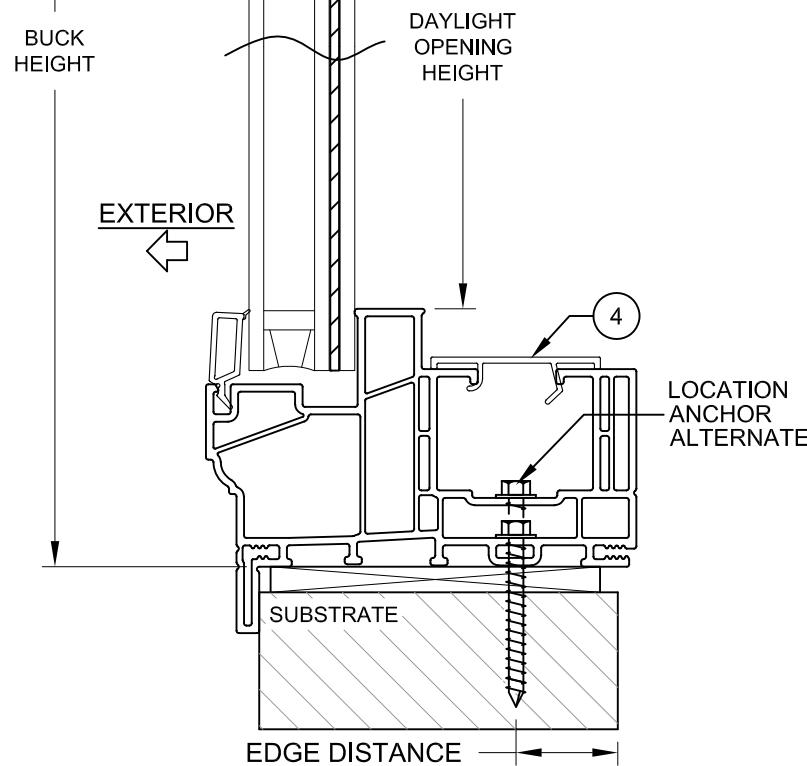

2 SILL FLANGE FRAME X-SECTION INTO 2X WOOD OR MASONRY

TABLE 2: INSTALLATION ANCHORS

Anchor	Substrate	Minimum Edge Distance	Minimum Embedment
#10 or #12 Steel or 410 SS Screw	Southern Pine (SG = .55)	9/16"	1-3/8"
	Aluminum, 6063-T5 min.	3/8"	0.050"
	Steel Stud, Gr. 33 min.	3/8"	0.045" (20 Ga)
	A36 Steel	3/8"	0.050"
3/16" Steel Ultracon+	Concrete (min. 2.9 ksi)	1"	1-3/4"
	UngROUTED CMU, (ASTM C-90)	1"	1-1/4"
	Southern Pine (SG = .55)	1"	1-3/8"
1/4" Steel Ultracon+	Concrete (min. 3.0 ksi)	1"	1-3/8"
	UngROUTED CMU, (ASTM C-90)	1"	1-1/4"
	Southern Pine (SG = .55)	1"	1-3/8"

1) ANCHOR MUST EXTEND A MINIMUM OF 3 THREADS BEYOND ANY METAL SUBSTRATE.

2) "UNGROUTED CMU" VALUES MAY BE USED FOR GROUTED CMU APPLICATIONS.

3) ALL ANCHOR HEAD TYPES ARE APPLICABLE.

INSTALLATION NOTES:

1) SEE SHEET 1 FOR ANCHOR SPACING REQUIREMENTS.

2) ANY INSTALLATION OPTION SHOWN (2X BUCK, 1X BUCK, DIRECT TO MASONRY, STEEL STUD) MAY BE USED ON ANY SIDE OF THE WINDOW.

3) USE ONLY SUBSTRATE APPROPRIATE ANCHORS LISTED IN ANCHOR TABLE. FOLLOW EMBEDMENT AND EDGE DISTANCE LIMITS. MAX. SHIM THICKNESS TO BE 1/4". ANY INSTALLATION OPTION SHOWN MAY BE USED ON ANY OR ALL SIDES OF THE WINDOW.

Rev.# 08/17/23
Date
MINOR EDITORIAL UPDATES
Rev.

PREPARED BY A. LYNN MILLER
1070 TECHNOLOGY DRIVE
N. VENICE, FL 34275
(941) 480-1600

REGISTRATION #29296
COPYRIGHT © 2023 PGT, INC., LIMITED LICENSE
TO MAKE COPIES FOR PERMITTING.

04/17/23
Date

LOGAN YODER
By

PW920V-FPA-LM HVHZ
DWG No.

7 OF 10
Sheet

PW920V
Series

VINYL FIXED WINDOW (LM - HVHZ)
Title

FLANGE INSTALL SECTION VIEWS
Desc.

Impact Resistant Windows & Doors

CGI WINDOWS AND DOORS
3780 W. 104TH STREET
HIALEAH, FL 33018

ANTHONY LYNN MILLER
LICENSE
No. 58705
08/18/23
STATE OF FLORIDA
PROFESSIONAL ENGINEER
A. LYNN MILLER, P.E.
P.E.# 58705

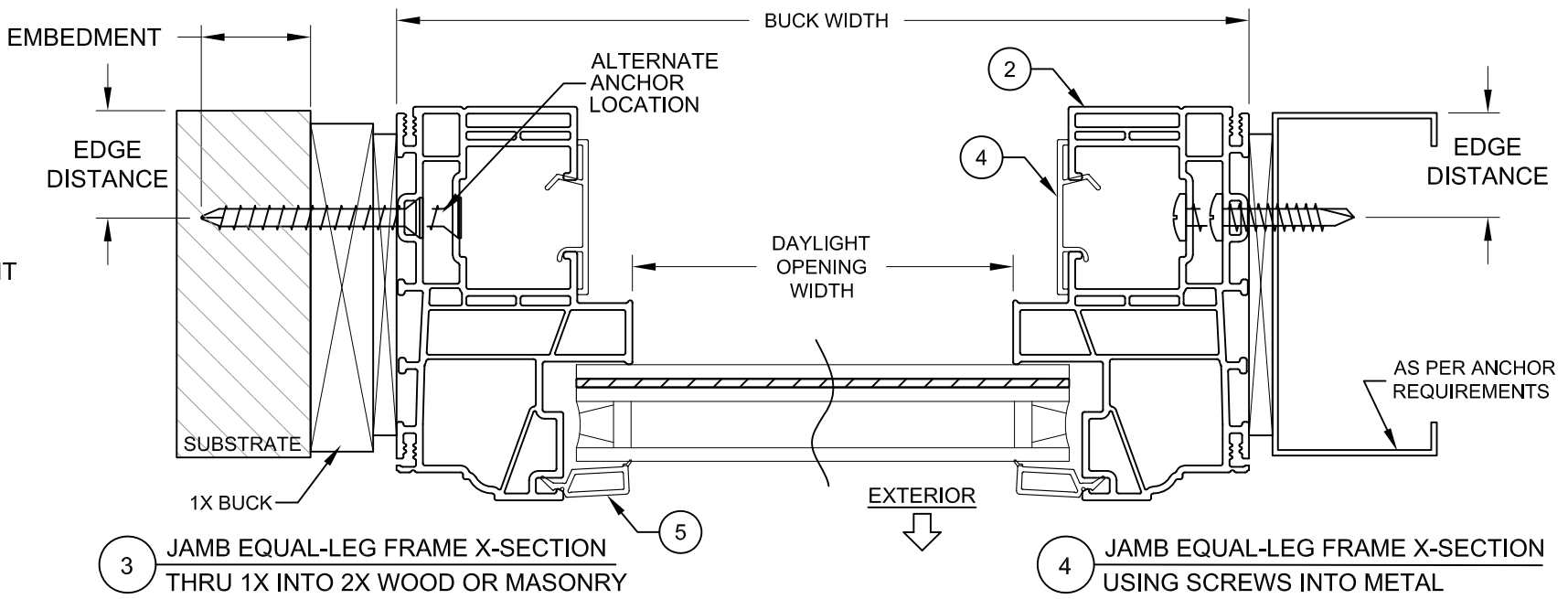
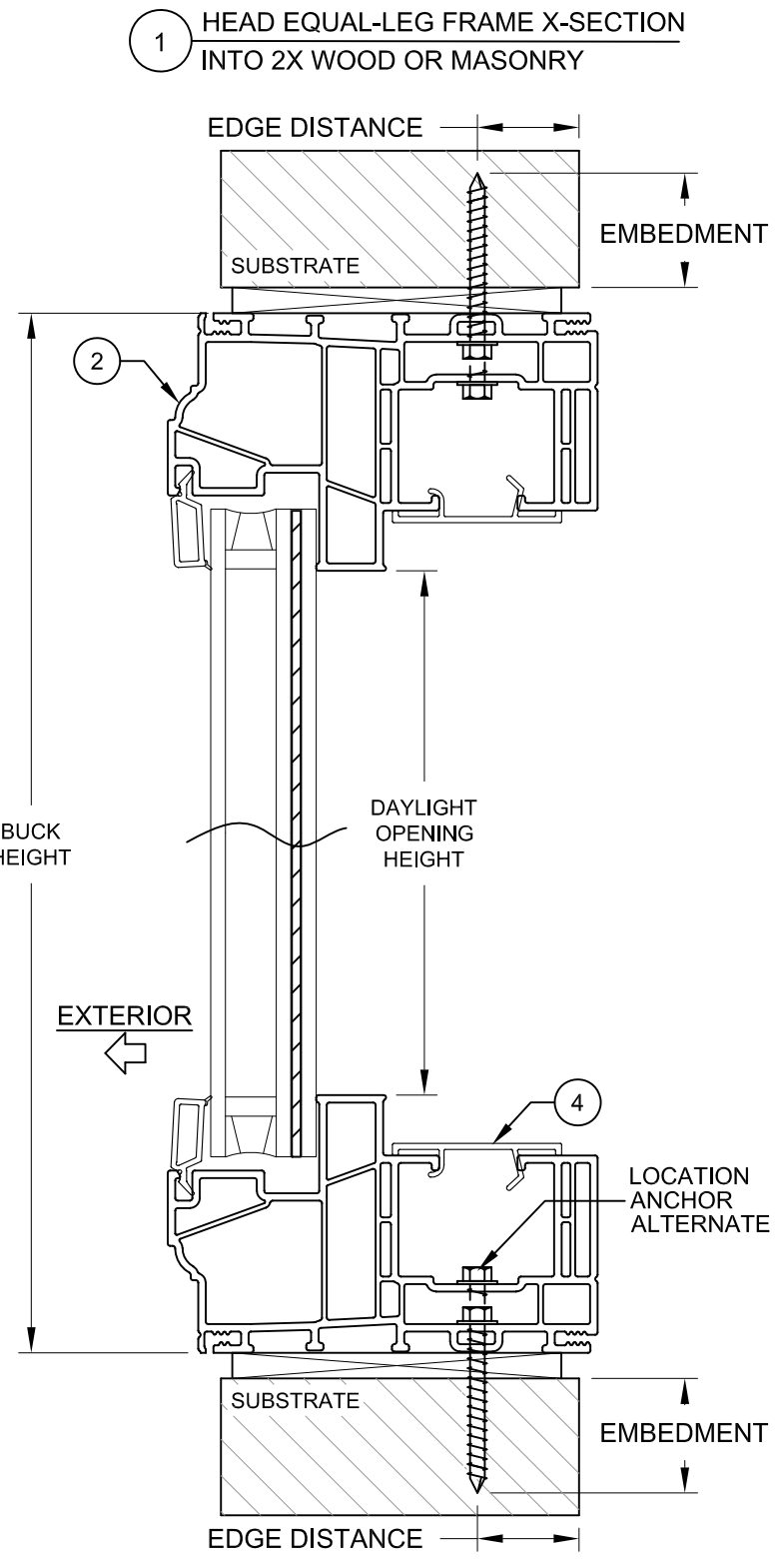

TABLE 3: INSTALLATION ANCHORS

Anchor	Substrate	Minimum Edge Distance	Minimum Embedment
#10 or #12 Steel or 410 SS Screw	Southern Pine (SG = .55)	9/16"	1-3/8"
	Aluminum, 6063-T5 min.	3/8"	0.050"
	Steel Stud, Gr. 33 min.	3/8"	0.045" (20 Ga)
	A36 Steel	3/8"	0.050"
3/16" Steel Ultracon+	Concrete (min. 2.9 ksi)	1"	1-3/4"
	UngROUTED CMU, (ASTM C-90)	1"	1-1/4"
	Southern Pine (SG = .55)	1"	1-3/8"
1/4" Steel Ultracon+	Concrete (min. 3.0 ksi)	1"	1-3/8"
	UngROUTED CMU, (ASTM C-90)	1"	1-1/4"
	Southern Pine (SG = .55)	1"	1-3/8"

- 1) ANCHOR MUST EXTEND A MINIMUM OF 3 THREADS BEYOND ANY METAL SUBSTRATE.
- 2) "UNGROUTED CMU" VALUES MAY BE USED FOR GROUTED CMU APPLICATIONS.
- 3) ALL ANCHOR HEAD TYPES ARE APPLICABLE.

INSTALLATION NOTES:

- 1) SEE SHEET 1 FOR ANCHOR SPACING REQUIREMENTS.
- 2) ANY INSTALLATION OPTION SHOWN (2X BUCK, 1X BUCK, DIRECT TO MASONRY, STEEL STUD) MAY BE USED ON ANY SIDE OF THE WINDOW.
- 3) USE ONLY SUBSTRATE APPROPRIATE ANCHORS LISTED IN ANCHOR TABLE. FOLLOW EMBEDMENT AND EDGE DISTANCE LIMITS. MAX. SHIM THICKNESS TO BE 1/4". ANY INSTALLATION OPTION SHOWN MAY BE USED ON ANY OR ALL SIDES OF THE WINDOW.

Rev.# 08/17/23
Date
MINOR EDITORIAL UPDATES
Rev.

PREPARED BY A. LYNN MILLER
1070 TECHNOLOGY DRIVE
N. VENICE, FL 34275
(941) 480-1600

REGISTRATION #29296
COPYRIGHT © 2023 PGT, INC., LIMITED LICENSE
TO MAKE COPIES FOR PERMITTING.

04/17/23
Date

LOGAN YODER
By

PW920V-FPA-LM HVHZ
No.

8 OF 10
Sheet

PW920V
Series

VINYL FIXED WINDOW (LM - HVHZ)
DESC. TITLE

EQUAL-LEG INSTALLATION SECTION VIEWS

Impact Resistant Windows & Doors

CGI WINDOWS AND DOORS
3780 W. 104TH STREET
HIALEAH, FL 33018

ANTHONY LYNN MILLER
LICENSE
No. 58705
08/18/23
STATE OF FLORIDA
PROFESSIONAL ENGINEER
A. LYNN MILLER, P.E.
P.E.# 58705

1 HEAD FIN FRAME X-SECTION USING NAILS INTO 2X WOOD

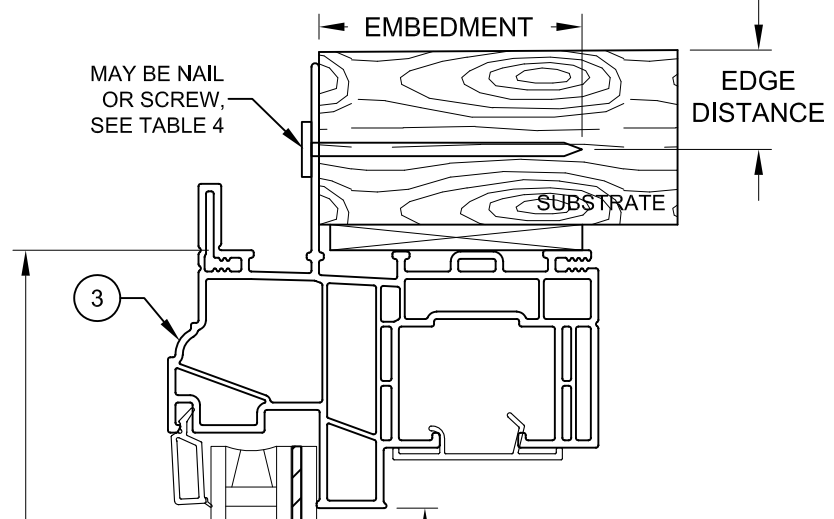

3 JAMB FIN FRAME X-SECTION USING SCREWS INTO 2X WOOD

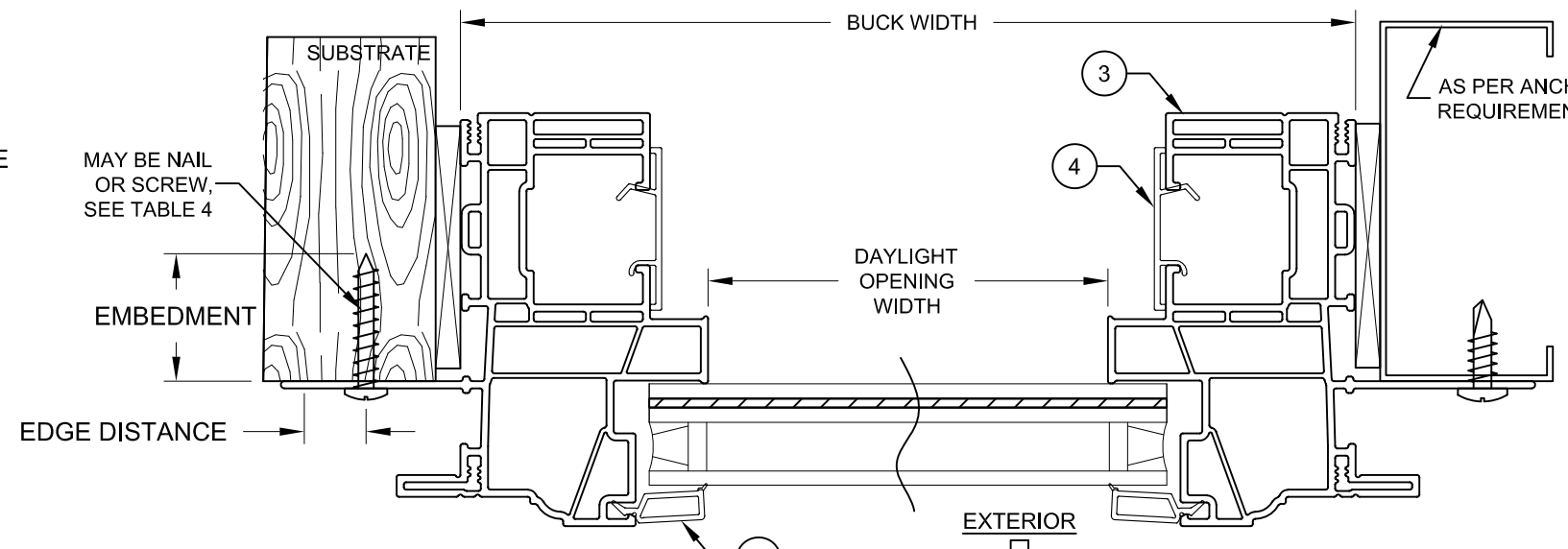

4 JAMB FIN FRAME X-SECTION USING SCREWS INTO METAL

HYBRID CONFIGURATIONS (FLANGE FRAME/FIN FRAME) ALLOWED WITH MULLION INSTALLATION, SEE PAGE 7 FOR FLANGE FRAME INSTALLATION DETAILS.

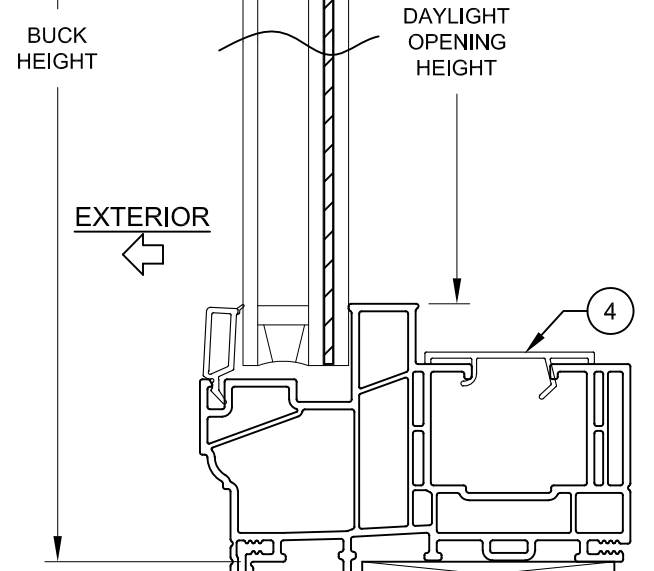

2 SILL FIN FRAME X-SECTION USING NAILS INTO 2X WOOD

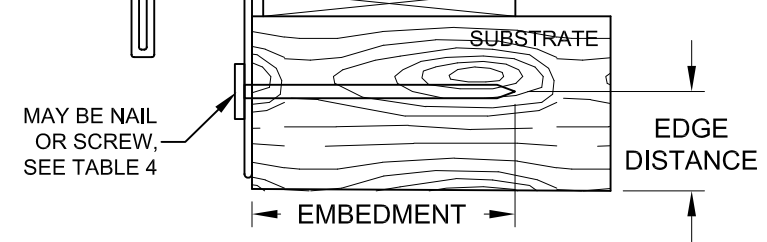

TABLE 4: INSTALLATION ANCHORS

Anchor	Substrate	Min. Edge Distance	Min. Embedment
2-1/2" x .113" Box Nail	P.T. Southern Pine (SG = .55)	5/16"	2-7/16"
2-1/2" x .131" Common Nail	P.T. Southern Pine (SG = .55)	3/8"	2-7/16"
2-1/2" x .145" Roofing Nail	P.T. Southern Pine (SG = .55)	3/8"	2-7/16"
#10 Steel SMS	P.T. Southern Pine (SG = .55)	1/2"	1-3/8"
	Aluminum, 6063-T5 min.	3/8"	1/8"
	Steel Stud, Gr. 33 min.	3/8"	0.036
	A36 Steel	3/8"	1/8"

1) ANCHOR MUST EXTEND A MINIMUM OF 3 THREADS BEYOND ANY METAL SUBSTRATE.
2) ALL ANCHOR HEAD TYPES ARE APPLICABLE.

INSTALLATION NOTES:

- 1) SEE SHEET 1 FOR SPACING REQUIREMENTS.
- 2) FLANGE AND/OR FIN MAY BE REMOVED TO CREATE OTHER APPROVED FRAME TYPE.
- 3) USE ONLY SUBSTRATE APPROPRIATE ANCHORS LISTED IN ANCHOR TABLE. FOLLOW EMBEDMENT AND EDGE DISTANCE LIMITS. ANY INSTALLATION OPTION SHOWN MAY BE USED ON ANY OR ALL SIDES OF THE WINDOW.
- 4) MAX. SHIM THICKNESS TO BE 1/4". MAX. SHIM SPACING TO BE 18".

PREPARED BY A. LYNN MILLER
1070 TECHNOLOGY DRIVE
N. VENICE, FL 34275
(941) 480-1600

REGISTRATION #29296
COPYRIGHT © 2023 PGT, INC., LIMITED LICENSE
TO MAKE COPIES FOR PERMITTING.

04/17/23
Date

LOGAN YODER
By

PW920V-FPA-LM HVHZ
No.

9 OF 10
Sheet

PW920V
Desc.

VINYL FIXED WINDOW (LM - HVHZ)
Title

FIN INSTALLATION SECTION VIEWS



CGI WINDOWS AND DOORS
3780 W. 104TH STREET
HIALEAH, FL 33018

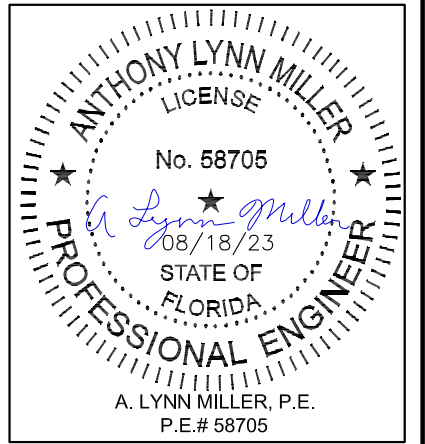

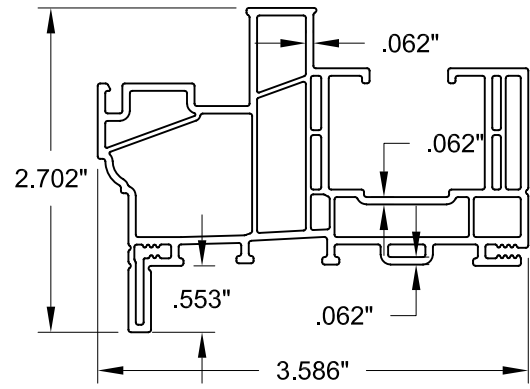

① FRAME, W/FLANGE

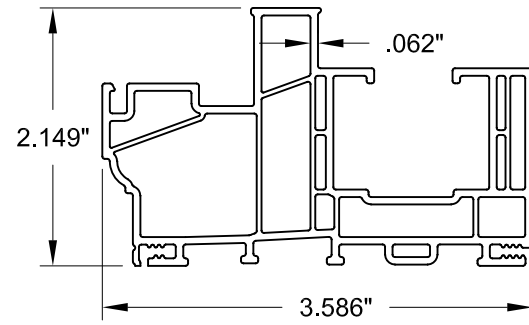

② FRAME, EQUAL LEG

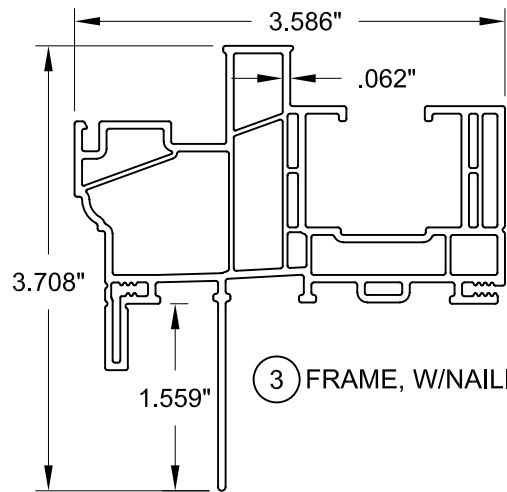

③ FRAME, W/NAILING FIN

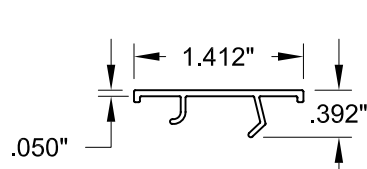

④ ANCHOR COVER

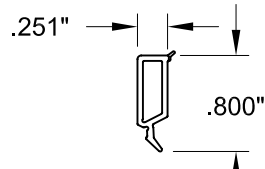

⑤ GLAZING BEAD

TABLE 5:

#	Part #	Description	Material
1	9465	Frame, w/Flange	PVC
2	9465	Frame, Equal Leg	PVC
3	9455	Frame, w/Nailing Fin	PVC
4	9473	Anchor Cover	PVC
5	9736	Glazing Bead	PVC
10		Backbedding: RGS7700, Dow 791/983/995	SILICONE
11		Metal or TPS Spacer	VARIES
12	7061	Setting Block, 1/8" x 7/8" x 2"	EPDM

THE APPROVED, RIGID PVC EXTERIOR EXTRUSIONS ARE TO BE PRODUCED BY EXTRUDERS' LICENSEES UNDER "AAMA CERTIFICATION PROGRAMS FOR RIGID PVC EXTRUSIONS".

Impact Resistant Windows & Doors CGI WINDOWS AND DOORS 3780 W. 104TH STREET HIALEAH, FL 33018	PREPARED BY A. LYNN MILLER 1070 TECHNOLOGY DRIVE N. VENICE, FL 34275 (941) 480-1600	REGISTRATION #29296 COPYRIGHT © 2023 PGT, INC., LIMITED LICENSE TO MAKE COPIES FOR PERMITTING.	No. 10 OF 10 Sheet	Date 04/17/23 Drawn By LOGAN YODER	Title PW920V-FPA-LM HVHZ Extrusions/BOM
	VINYL FIXED WINDOW (LM - HVHZ)	PW920V	10 OF 10	04/17/23	PW920V-FPA-LM HVHZ

ANTHONY LYNN MILLER
 LICENSE
 No. 58705
 08/18/23
 STATE OF FLORIDA
 PROFESSIONAL ENGINEER
 A. LYNN MILLER, P.E.
 P.E.# 58705

Rev. # 08/17/23
Date 08/17/23
MINOR EDITORIAL UPDATES
Rev. # A